

EUROPEAN

TOOLING SYSTEMS

www.europeantooling.com



European Tooling Systems, Inc.

205 Creekside Drive Washington, NC 27889

2015-2016 Catalog

1-800-835-3660

252-975-2241-fax

Email: eupeantooling@earthlink.net

Website: www.eupeantooling.com

High Speed Corrugated Steel & replacement knives to fit Williams & Hussey	Page 1
Planer Knives - HSS & Carbide Tipped	Page 2
Saw Blades	Pages 3-5
Brad Point (Dowel) Bits, 57mm & Jobber Solid Carbide, Adapters, Countersinks	Page 6
Brad Point (Dowel) Bits, 70mm, 77mm, 85mm & Ayen Bits	Page 7
Thru-Bore Bits, 58mm, 70mm, & 77mm	Page 7
Hinge Bits, 57 mm, 70mm & 3-Wing Hinge Bits	Page 8
Solid Carbide Dowel and Thru Bore Bits	Page 8
 High Speed Steel Boring Bits	Pages 9-10
Custom Counterbore and Countersink 2-step Drill Bits	Page 11
8mm Shank Bits, Grass America, Hafele & Conformat Bits	Page 12
Spoilboard Cutters, Diamond Router Bits, Insert Router Bits	Page 12
Insert Knives - Straight	Page 13
Insert Knives - Radius, Face Groove and Back Groove	Page 14
CNC Tool Holders & Collets	Page 15
Solid Carbide Router Bits - Up Cut/Down Cut & Compression & Corner Round Bits	Page 16
TCT Plunge Bits, Laminate Trim & TCT Dovetail	Page 17

where **Quality** meets **Quantity**

CORRUGATED BACK KNIFE

STOCK

HIGH SPEED STEEL 25" KNIVES WITH 60 DEGREE
CORRUGATIONS

BAR SIZE	PART #
1/4 x 1-1/4 x 25	6200-1/4-11/4
1/4 x 1-1/2 x 25	6200-1/4-11/2
1/4 x 1-3/4 x 25	6200-1/4-13/4
1/4 x 2 x 25	6200-1/4-2
1/4 x 2-1/4 x 25	6200-1/4-21/4
1/4 x 2-1/2 x 25	6200-1/4-21/2
BAR SIZE	PART #
5/16 x 1-1/4 x 25	6200-5/16-11/4
5/16 x 1-1/2 x 25	6200-5/16-11/2
5/16 x 1-3/4 x 25	6200-5/16-13/4
5/16 x 2 x 25	6200-5/16-2
5/16 x 2-1/4 x 25	6200-5/16-21/4
5/16 x 2-1/2 x 25	6200-5/16-21/2
5/16 x 2-3/4 x 25	6200-5/16-23/4
5/16 x 3 x 25	6200-5/16-3
FILLER STEEL	PART #
5/16 x 1 x 25	6200-5/16-1"

REPLACEMENT KNIVES FOR WILLIAMS & HUSSEY

Stocking Corrugated & Smooth

BAR SIZE - Smooth	PART #
1/4 x 1 3/4 25	6400-1/4-1 3/4
1/4 x 2 x 25	6400-1/4-2
1/4 x 2 1/4 x 25	6400-1/4-2 1/4
1/4 x 2 1/2 x 25	6400-1/4-2 1/2
5/16 x 2 3/4 x 25	6400-5/16-2 3/4
BAR SIZE - Corrugated	PART #
1/4 x 2 x 25	6400-1/4-2C
1/4 x 2-1/4 x 25	6400-1/4-2 1/4C
1/4 x 2-1/2 x 25	6400-1/4-2 1/2C

Replacement Knives To Fit TeraTM Brand

Available in M2, M42 and Solid Carbide

60
80
100
110
120
130
150
170
180
210
230
250
260
280
300
310
330
350
360
400
410
420
430
450
500
510
520
530
540
610
630
635
640
650



PLANNER KNIVES

NUMBER	BAR SIZE	GRADE	SET	MACHINE
STB4625125	4 x 5/8 x 1/8	T1 or TCT	3	Delta, Atlas, Craftsman
STB6625125	6 x 5/8 x 1/8	T1 or TCT	3	Delta, Craftsman, Rockwell
STB6625125A	6 x 5/8 x 1/8	T1	4	Boice Crane
PKH-14803	6 x 16.5mm x 2.7mm	T1	3	Delta37-195, 37-275, 190
STB675125	6 x 3/4 x 1/8	T1 or TCT	3	Powermatic
PKH-14801	6 x 7/8 x 1/16	T1	2	Delta 37-070, JT160
STB61125	6 x 1 x 1/8	T1 or TCT	3	Grizzly
STB6-1/16625125	6-1/16 x 5/8 x 1/8	T1 or TCT	3	Powermatic, Jet J1-6
STB6-1/1675125	6-1/16 x 3/4 x 1/8	T1 or TCT	3	Delta, Walker-Tuner
STB6062812125	6-1/16 x 13/16 x 1/8	T1 or TCT	3	Delta
STB6125625093	6-1/8 x 5/8 x 3/32	T1	3	Delta
STB6125625125	6-1/8 x 5/8 x 1/8	T1	3	Craftsman
STB6125688125	6-1/8 x 11/16 x 1/8	T1 or TCT	3	Jet
STB8625125	8 x 5/8 x 1/8	T1 or TCT	3	Delta, Crane, Rockwell
STB875125	8 x 3/4 x 1/8	T1 or TCT	3	Jet, Powermatic, Pryor
STB875125A	8 x 3/4 x 1/8	T1 or TCT	4	Bridgewood
STB8875125	8 x 7/8 x 1/8	T1 or TCT	3	Powermatic
STB81125	8 x 1 x 1/8	T1 or TCT	3	Grizzly
STB80626093	8-1/16 x 5/8 x 3/32	T1	3	Delta
STB8-1/16625125	8-1/16 x 5/8 x 1/8	T1	3	Delta
STB8-1/1675125	8-1/16 x 3/4 x 1/8	T1 or TCT	3	Sunhill Machinery
STB8062812125	8-1/16 x 13/16 x 1/8	T1 or TCT	3	Delta
PKH-12804	12 x 15/32 x 1/16	T1	2	Craftsman (Double Edge)
PKH-12810	12 x 3/4 x 1/16	T1	2	Delta (Double Edge)
STB1275125	12 x 3/4 x 1/8	T1	3	Grizzly
STB12875125	12 x 7/8 x 1/8	T1 or TCT	3	Powermatic, Parks
STB121125	12 x 1 x 1/8	T1 or TCT	3	Craftsman
STB12125125	12 x 1-1/4 x 1/8	T1 or TCT	3	Northfield
STB122575125	12-1/4 x 3/4 x 1/8	T1	3	Boice Crane, Reliant, Wilke
STB1225875125	12-1/4 x 7/8 x 1/8	T1 or TCT	3	Powermatic
STB12251125	12-1/4 x 1 x 1/8	T1 or TCT	3	European Combo
PKH-12803	12-1/2 x 15/32 x 1/16	T1	2	Delta, Ryobi (Dbl Edge)
STB12562525	12-1/2 x 5/8 x 1/8	T1	3	Boice Crane
STB1250687125	12-1/2 x 11/16 x 1/8	T1 or TCT	3	RBI, Foley, Jet
STB125075125	12-1/2 x 3/4 x 1/8	T1 or TCT	3	Jet, Grizzly, Reliant
PKH-12801	12-1/2 x 7/8 x 1/16	T1	3	Dewalt (Double Edge)
PKH-12809	12-1/2 x 1-1/16 x 1/8	T1	2	Dewalt
PKH-12802	13 x 15/32 x 1/16	T1	2	Dewalt, Delta (Dbl Edge)
PKH-12806	13 x 1/2 x 1/16	T1	2	Ryobi, AP1300(Dbl Edge)
PKH-12807	13 x 3/4 x 1/16	T1	2	Ryobi, TP1300(Dbl Edge)

NUMBER	BAR SIZE	GRADE	SET	MACHINE
PKH-12826	13 x 3/4 x 1/16	T1	2	Ryobi AP1301 (Dbl Edge)
PKH-12800	13 x 7/8 x 1/16	T1 or TCT	3	Dewalt (HSS is Dbl Edge)
STB13062625125	13-1/16 x 5/8 x 1/8	T1 or TCT	3	Jet
STB131251116152	13-1/8 x 11/16 x 5/32	T1	3	Delta (no slots in knife)
STB131251125	13-1/8 x 1 x 1/8	T1 or TCT	3	Delta, Rockwell
STB151125	15 x 1 x 1/8	T1 or TCT	3	Delta, Grizzly, Woodtech
STB15-1/161125	15-1/16 x 1 x 1/8	T1	3	Delta
STB15751187125	15-3/4 x 30mm (1-3/16) x 3mm (1/8)	T1 or TCT	4	SCMI
STB161125	16 x 1 x 1/8	T1	3	Jet JWP 16
STB161125125	16 x 1-1/8 x 1/8	T1	4	Bridgewd, Crescent, Grizzly
STB16125125	16 x 1-1/4 x 1/8	T1 or TCT	3	Northfield
STB161871187125	16-3/16 x 30mm (1-3/16) x 3mm (1/8)	T1 or TCT	4	SCMI
STB1625125156	16-1/4 x 1-1/4 x 5/32	T1 or TCT	3	Powermatic
STB1650687125	16-1/2 x 11/16 x 1/8	T1 or TCT	4	RBI
STB18125156	18 x 1-1/4 x 5/32	T1 or TCT	3	Powermatic
STB181251125156	18-1/8 x 1-1/8 x 5/32	T1 or TCT	3	Rockwell, Delta
STB1825125156	18-1/4 x 1-1/4 x 5/32	T1 or TCT	3	Powermatic
STB1825687125	18-1/2 x 11/16 x 1/8	T1 or TCT	3	Woodmaster
STB201125	20 x 1 x 1/8	T1 or TCT	3	Grizzly, Northwood
STB201125A	20 x 1 x 1/8	T1 or TCT	4	Parks, Jet, Northstate
STB201125125	20 x 1-1/8 x 1/8	T1 or TCT	4	Delta
STB201187125	20 x 1-3/16 x 1/8	T1 or TCT	4	Delta
STB20125125	20 x 1-1/4 x 1/8	T1	3	Woodtek
STB201871187125	20-3/16 x 1-3/16 x 1/8	T1 or TCT	4	Delta
STB201871375125	20-3/16 x 1-3/8 x 1/8	T1 or TCT	4	Delta
STB2025125156	20-1/4 x 1-1/4 x 5/32	T1 or TCT	3	Powermatic
STB2050687125	20-1/2 x 11/16 x 1/8	T1 or TCT	4	RBI
STB20501187125	20-1/2 x 30mm x 3mm	T1 or TCT	4	SCMI
STB221251125	22-1/8 x 1 x 1/8	T1	4	Powermatic, Northfield
STB24125156	24 x 1-1/4 x 5/32	T1 or TCT	4	Powermatic, Northfield
STB241251187125	24-1/8 x 1-3/16 x 1/8	T1 or TCT	4	Grizzly
STB24251125125	24-1/4 x 1-1/8 x 1/8	T1 or TCT	3	Delta
STB24251125125A	24-1/4 x 1-1/8 x 1/8	T1 or TCT	4	Delta
STB24751125125	24-3/4 x 1-1/8 x 1/8	T1 or TCT	3	Jet
ST248121375125	24-13/16 x 1-3/8 x 1/8	T1 or TCT	4	Delta
STB25687125	25 x 11/16 x 1/8	T1 or TCT	3	Woodmaster
STB25125125	25 x 1-1/4 x 1/8	T1 or TCT	4	Powermatic
STB25138125	25 x 1-3/8 x 1/8	T1 or TCT	4	Pinerho
STB251871375125	25-3/16 x 1-3/8(35mm) x 1/8	T1 or TCT	4	SCMI
STB312156	31 x 2 x 5/32	T1	1	SCMI

SAW BLADES

ALTENDORF SAW

300 x 3.2/2.2 x 30 z=60 ATB	1000-300-60 ATB
300 x 3.2/2.2 x 30 z=60 TC	1000-300-60
300 x 3.2/2.2 x 30 z=72 TC	1000-300-72TC
300 x 3.2/2.2 x 30 z=72 ATB	1000-300-72ATB
300 x 4.4/3.0 x 30 z= 60 TC	1000-300-60-4
300 x 4.4/3.0 x 30 z= 72 TC	1000-300-72-4
350 x 3.2/2.5 x 30 z=72 TC	1000-350-72TC
350 x 3.2/2.5 x 30 z=72ATB	1000-350-72ATB

GABBIANI SAW

355 x 4.4/3.0 x 80 z=72	1000-355-80
380 x 4.4/3.0 x 80 z=72	1000-380-80
400 x 4.4/3.0 x 80 z=72NPH	1000-400-80
400 x 4.4/3.0 x 80 z=72NPH	1000-400-80ATB
420 x 4.4/3.2 x 80 z=72	1000-420-80
420 x 4.8/3.5 x 80 z=72TC	1000-420-80-8
430 x 4.4/3.0 x 80 z=72	1000-430-80
430 x 4.4/3.5x 80 x z=72TC	1000-430-80-3.5
450 x 4.4/3.0 x 80 z=72	1000-450-80
450 x 4.4/3.0 x 80 z=72ATB	1000-450-72ATB
450 x 4.4/3.0 x 80 z=72NPH	1000-450-80NPH

GIBEN SAW

300 x 4.4/3.0 x 75 z=72	1000-300-75
320 x 4.4/3.0 x 50 z=60	1000-320-50
320 x 4.4/3.0 x 75 z=60	1000-320-75
320 x 4.4/3.0 x 50 z=72	1000-320-50-72
350 x 4.4/3.0 x 50 z=54	1000-350-50
350 x 4.4/3.2 x 50 z=72TC	1000-350-50-72
355 x 4.4/3.0 x 75 z=54	1000-355-75
355 x 4.4/3.0 x 75 z=72	1000-355-75-72
380 x 4.4/3.0 x 50 z=72	1000-380-50
380 x 4.8/3.2 x 75 z-72	1000-380-50-8
400 x 4.4/3.2 x 75 z=72	1000-400-75
430 x 4.4/3.2 x 75 z=72	1000-430-75-72
430 x 4.4/3.2 x 75 z= 96	1000-430-75-96
470 x 4.4/3.2 x 75 z=72	1000-470-75-72
470 x 4.4/3.2 x 75 z=96	1000-470-75
470 x 4.8/3.5 x 75 z=72	1000-470-72-8
470 x 4.8/3.5 x 75 z=96	1000-470-75-8
550 x 5.0/3.5 x 100 z=72	1000-550-100

HOLZHER SAW

220 x 3.2/2.0 x 30 z=42 HOL P	1000-220-POS
220 x 3.2/2.0 x 30 z=42 HOL N	1000-220-NEG
220 x 3.2/2.0 x 30 z=48 TC	1000-220-48TC
220 x 3.2/2.0 x 30 z=64 TC	1000-220-30
220 x 3.2/2.0 x 30 z=64ATB	1000-220-30NEG
380 x 4.4/3.0 x 75 z=72	1000-380-75

HOLZMA SAW

350 x 4.4/3.0 x 60 z=72	1000-350-60
380 x 4.4 x 60 z=72	1000-380-60-4
380 x 4.4/3.2 x 75 z=72	1000-380-75
380 x 4.8/3.5 x 60 z=72	1000-380-60
380 x 4.8/3.5 x 60 z=72ATB	1000-380-60ATB
400 x 4.4/3.2 x 60 z=72	1000-400-60
420 x 4.4/3.2 x 60 z=72	1000-420-60
450 x 4.4/3.2 x 75 z=72	1000-450-75
450 x 4.8/3.5 x 60 z=60	1000-450-60-60

HOLZMA SAW CONT'D

450 x 4.8/3.5 x 60 z=72	1000-450-60
500 x 4.8/3.5 x 60 z=60	1000-500-60-8
500 x 4.8/3.5 x 60 z=72	1000-500-72-8
520 x 4.8/3.5 x 60 z=60	1000-520-60
520 x 4.8/3.5 x 60 z=72	1000-520-72
600 x 5.8/4.0 x 60 z=60	1000-600-60
600 x 5.8/4.0 x 60 z=72	1000-600-72

SCHELLING SAW

350 x 4.4/2.0 x 30 z=54	1000-350-30-54
350 x 4.4/3.0 x 30 z=72	1000-350-30-72
370 x 4.4/3.0 x 30 z=72	1000-370-30
400 x 4.4/3.0 x 30 z=60	1000-400-30-60
400 x 4.4/3.2 x 30 z=72	1000-400-30
450 x 4.4/3.2 x 30 z=72	1000-450-30
460 x 4.4/3.2 x 30 z-72	1000-460-30
460 x 4.8/3.5 x 30 z=72	1000-460-30-8
480 x 4.4/3.2 x 30 z=80	1000-480-30
520 x 5.0/3.5 x 30 z=60	1000-520-30-60

SCMI

300 x 3.2/2.2 x 1" z=72	1000-300-1"
300 x 4.4/3.0 x 80 z=72	1000-300-80
350 x 3.2 x 25.4 z=42TC	1000-350-1-42
350 x 3.5/2.5 x 30 z=84	1000-350-30-35
350 x 3.5/2.5 x 1"z=84	1000-350-1"
350 x 4.4/3.0 x 80 z=72	1000-350-SCMI
350 x 4.4/3.0 x 1-1/4 z=72	1000-350-1 1/4
355 x 4.4/3.0 x 80 z=54	1000-355-80-54

SELCO SAW

300 x 4.4/3.0 x 65 z=60	1000-300-65-60
300 x 4.4/3.0 x 65 z=72	1000-300-65-72
320 x 4.4/3.0 x 65 z=60	1000-320-65
355 x 4.4/3.0 x 80 z=72	1000-355-SELCO
360 x 4.4/3.0 x 65 z=72	1000-360-65
400 x 4.4/3.2 x 80 z=72	1000-400-SELCO
430 x 4.4/3.2 x 80 z=72	1000-430-SELCO
430 x 4.4/3.2 x 80 z=72ATB	1000-430-80ATB
430 x 4.8/3.5 x 80 z=72	1000-430-80-8
450 x 4.4/3.2 x 80 z=72	1000-450-SELCO
450 x 4.8/3.5 x 80 z=72	1000-450-80-8
480 x 4.8/3.5 x 80 z=72	1000-480-80

STRIEBIG SAW

250 x 3.2/2.2 x 30 z=60 TC	1000-250-60TC
250 x 3.2/2.2 x 30 z=48 H P	1000-250-30POS
250 x 3.2/2.0 x 30 z=48 H N	1000-250-30NEG
250 x 3.2/2.2 x 30 z=80 TC	1000-250-80TC
250 x 3.2/2.2 x 30 z=80ATB N	1000-250-80NEG
300 x 3.2/2.2 x 30 z=60 H P	1000-300-30POS
300 x 3.2/2.2 x 30 z=60 H N	1000-300-30NEG
300 x 3.2/2.2 x 30 z=96	1000-300-30-96
300 x 3.2/2.2 x 30 z=96 NATB	1000-300-96ATB
350 x 3.2/2.2 x 30 z=84 H P	1000-350-84POS

SCORING SAW BLADES

80 x 2.8 x 20 x 2 x 10	1000-080-20
100 x 3.0 x 20 x 2 x 12	1000-100-20-2P
100 x 3.0 x 3/4 x 2 x 12	1000-100-3/4
100 x 3.0 x 22 x 2 x 12	1000-100-22
100 x 3.2/22x20z=20ATB	1000-100-22
120 x 2.8 x 3/4 x 2 x 12	1000-120-3/4
120 x 2.8 x 3/4 x 2 x 12	1000-120-20-2P
120 x 2.8 x 22 x 2 x 12	1000-120-22-2P
120 x 2.8 x 50 x 2 x 12	1000-120-RAPIDO
120 x 3.0 x 22 z=24	1000-120-24
120 x 4.4 x 3/4 z=36	1000-120-44
125 x 2.8 x 22 x 2 x 12	1000-125-22-2P
125 x 3.0 x 20 x 2 x 12	1000-125-20-2P
125 x 3.1 x 20 z=24	1000-125-20
125 x 3.1 x 22 z=24	1000-125-22
125 x 4.4 x 45 z=24	1000-125-45
127 x 4.4 x 45 z=24	1000-127-45
140 x 4.4 x 45 z=24	1000-140-45
150 x 4.4 x 30 z=28	1000-150-30
150 x 4.4 x 11/4 z=24	1000-150-1 1/4
150 x 4.4 x 11/4 z=28ATB	1000-150-ATB
150 x 4.4 x 45 z=36	1000-150-45
160 x 2.8 x 22 x 2 x 16	1000-160-22
160 x 4.4 x 20 z=36	1000-160-20
160 x 4.4 x 45 z=28	1000-160-45
160 x 4.4 x 55 z=36	1000-160-55
180 x 4.4 x 30 z=30	1000-180-30
180 x 4.4 x 45 z=36	1000-180-45
180 x 4.4 x 50 z=36	1000-180-50
180 x 4.4 x 50 z=36 3.2pl	1000-180-50-32
180 x 4.8 x 45 z=36	1000-180-45-8
180 x 4.8 x 45 z=36ATB	1000-180-45-ATB
180 x 4.8 x 50 z=36	1000-180-50-8
180 x 5.0 x 55 z=36	1000-180-55
200 x 4.4 x 20 z=36	1000-200-20
200 x 4.4 x 20 z=36 HUB	1000-200-HUB
200 x 4.4 x 30 z=36	1000-200-30
200 x 4.4 x 45 z=36	1000-200-45
200 x 4.4 x 45 z=36ATB	1000-200-45-ATB
200 x 4.4 x 50 z=36	1000-200-50
200 x 4.4 x 65 z=36	1000-200-65
200 x 4.4 x 80 z=36	1000-200-80
200 x 4.8 x 20 z=36	1000-200-20-8
200 x 4.8 x 20 z=36ATB	1000-200-20-8A
200 x 4.8 x 30 z=36	1000-200-30-8
200 x 4.8 x 45 z=36	1000-200-45-8
200 x 4.8 x 45 z=36ATB	1000-200-8-ATB
200 x 4.8 x 60 z=36	1000-200-60
200 x 4.8 x 65 z=36	1000-200-65-8
200 x 4.8 x 80 z=36	1000-200-80-8
200 x 5.8 x 45 z=36	1000-200-45-5
215 x 4.4 x 50 z=42	1000-215-50
215 x 4.4 x 50 z=42 (2/7/80)	1000-215-50S
215 x 4.8 x 50 z=42	1000-215-50-8
300 x 4.4 x 20 z=42	1000-300-20
300 x 4.2-4.6 x 50 z=2x32	1000-300-50-2P
300 x 4.4 x 30 z=48 CON	1000-300-30
300 x 4.4 x 50 z=36	1000-300-50
300 x 4.4 x 65 z=48	1000-300-65
320 x 4.8 x 45 z=48	1000-320-45
340 x 4.8 x 45 z=72	1000-340-45

Conical



TRIM BLADES

90 x 3.0 x 30 z=20ATB	1000-090-30
90 x 3.2 x 30 z=20 LH	1000-090-30-L
90 x 3.2 x 30 z=20 RH	1000-090-30-R
100 x 2.4 x 22 z=20RH	1000-100-22RH
100 x 2.4 x 22 z=20LH	1000-100-22LH
100 x 2.4 x 22 z=12ATB	1000-100-24
100 x 2.4 x 32 z=30LH	1000-100-32-L
100 x 2.4 x 32 z=30RH	1000-100-32-R
100 x 2.6 x 30 z=24ATB	1000-100-30
100 x 2.6 x 32 z=30ATB	1000-100-32
100 x 3.0 x 32 z=20RH	1000-100-32 RH
100 x 3.0 x 32 z=20LH	1000-100-32 LH
100 x 3.2 x 20 z=20ATB	1000-100-20
100 x 3.2 x 22 z=24LH	1000-100-22L
100 x 3.2 x 22 z=24RH	1000-100-22R
100 x 3.2 x 32 z=30RH	1000-100-32R
100 x 3.2 x 32 z=30LH	1000-100-32L
110 x 2.4 x 32 z=40LH	1000-110-32L
110 x 2.4 x 32 z=40RH	1000-110-32R
110 x 3.0 x 30 z=30LH	1000-110-30LH
110 x 3.0 x 30 z=30RH	1000-110-30RH
110 x 3.6 x 20 z=20ATB	1000-110-20
110 x 3.6 x 22 z=20ATB	1000-110-20ATB
110 x 3.6 x 20 z=20R	1000-110-20R
110 x 3.6 x 20 z=20L	1000-110-20L
110 x 3.6 x 22 z=20 RH	1000-110-22R
110 x 3.6 x 22 z=20 LH	1000-110-22L
115 x 2.6 x 30 z=24ATB	1000-115-24ATB
115 x 3.2 x 52 z=30LH	1000-115-52L
115 x 3.2 x 52 z=30RH	1000-115-52R
115 x 3.2 x 56 z=30LH	1000-115-56L
115 x 3.2 x 56 z=30RH	1000-115-56R
120 x 3.0 x 30 z=20ATB	1000-120-30ATB
120 x 3.2 x 32 z=20ATB	1000-120-32
120 x 3.6 x 40 z=24ATB	1000-120-40
120 x 3.6 x 40 z=24 4ph 52	1000-120-40-52
125 x 3 x 30 z=24 RH	1000-125-30RH
125 x 3 x 30 z=24 LH	1000-125-30LH
125 x 3.5 x 20 z=36 RH	1000-125-20RH
125 x 3.5 x 20 z=36 LH	1000-125-20LH
140 x 3.2 x 22 z=32ATB	1000-140-22
140 x 3.2 x 30 z=32L	1000-140-30LH
140 x 3.2 x 30 z=32R	1000-140-30RH
140 x 3.2 x 30 z=32ATB	1000-140-32ATB
150 x 3.2 x 20 z=36L	1000-150-20LH
150 x 3.2 x 20 z=36R	1000-150-20RH
150 x 3.2 x 30 z=24L	1000-150-30LH
150 x 3.2 x 30 z=24R	1000-150-30RH
150 x 3.8 x 35 z=48RH	1000-150-35 R
150 x 3.8 x 35 z=48LH	1000-150-35 L
150 x 4.0 x 30 z=24	1000-150-30-24
160 x 3.2 x 30 z=24ATB	1000-160-30ATB
160 x 3.2 x 22 z=48ATB	1000-160-48ATB
160 x 3.6 x 30 z=24ATB	1000-160-30-36
170 x 3.2 x 30 z=36LH	1000-170-30-L
170 x 3.2 x 30 z=36RH	1000-170-30-R

GROOVER BLADES

100 x 3.0 x 30 z=12	1000-100-3
100 x 3.2 x 30 z=12	1000-100-30-32
100 x 3.5 x 20 z=20GR	1000-100-20-35
100 x 4 x 20 x z=12	1000-100-4
100 x 4.0 x 30 z=12GR	1000-100-30-4
100 x 7.0 x 20 z=12GR	1000-100-7-20
100 x 7.0 x 30 z=12GR	1000-100-7
120 x 3.0 x 30 z=12GR	1000-120-3
120 x 4.0 x 30 z=12GR	1000-120-4
120 x 6.0 x 20 z=12GR	1000-120-6
120 x 7.0 x 30 z=12GR	1000-120-7
120 x 7 x 3.5 z=12	1000-120-7-35
120 x 8 x 30 z=12	1000-120-8
125 x 4 x 30 z=12	1000-125-4
150 x 4.0 x 30 z=12GR	1000-150-30-4
150 x 7 x 30 z=12	1000-150-7-30
160 x 7 x 30 z=12	1000-160-7-30
180 x 7 x 30 z=12	1000-180-7

Flat Top



Triple Chip "TC"



Top Bevel ATB



LH



RH

** SOME OF THE TRIM AND GROOVER BLADES ARE CUSTOM ORDER**

BISCUIT CUTTER

100 x 4 x 22 z=12ATB (+12) LAM10012

COMBINATION SAWS (ATB W/RAKER)

10 x .125 x 5/8 z=50ATB (+15) CBS1050
 12 x .155 x 1 z=60ATB (+15) CBS1260
 14 x .155 x 1 z=70ATB (+15) CBS1470
 16 x .165 x 1 z=80ATB (+15) CBS1680

COMPOUND MITRE

8-1/2 x .098 x 5/8 z=36ATB H81236
 8-1/2 x .098 x 5/8 z=60ATB H81260A
 8-1/2 x .098 x 5/8 z=60TC H81260T

COUNTERTOP SAWS (TC45)

16 x .150 x 1 z=120TC (-2) CT1620

DADO CHIPPERS

12 x 1/16 x 1 (+15) DC1216
 12 x 1/8 x 1 (+15) DC1218

DADO SETS

8 x 1/4-13/16 z 5/8 z=24 (0) DS8
 10 x 1/4-13/16 x 1 z=24 (+15) DS101
 12 x 1/4-13/16 x 1 z=24 (+15) DS12

DOUBLE FACE LAMINATE

8 x .115 x 5/8 z=60ATB (-5) DFL86030
 10 x .115 x 5/8 z=80TC (-5) DFL1080
 10 x .115 x 5/8 z=80ATB (-5) DFL108030
 12 x .125 x 1 z=100TC (-5) DFL1210
 12 x .125 x 1 z=100ATB (-5) DFL121030
 14 x .150 x 1 z=100TC (-2) DFL1410
 14 x .148 x 1 z=100ATB (-2) DFL141030
 16 x .150 x 1 z=120ATB (-2) DFL162030
 220 x .125 x 30 z=64ATB (-5) DFL2206430
 250 x .125 x 30 z=80ATB (-5) DFL2508030

GENERAL PURPOSE CUT OFF

9 x .125 x 5/8 z=40ATB (+15) GP940A
 10 x .125 x 5/8 z=40ATB (+15) GP1040A
 10 x .125 x 5/8 z=40TC (+15) GP1040T
 12 x .135 x 1 z=40TC (+15) GP1240T
 12 x .135 x 1 z=40ATB (+15) GP1240A
 14 x .165 x 1 z=40ATB (+15) GP1440A
 14 x .165 x 1 z=40TC (+15) GP1440T
 16 x .165 x 1 z=40ATB (+15) GP1640A

GLUE LINE RIP SAWS

10 x .145 x 5/8 z=30TC (+20) GL1030
 12 x .160 x 1 z=30TC (+20) GL1230
 12 x .160 x 3-1/8 z=36TC (+20) GL1236
 14 x .170 x 1 z=36TC (+20) GL1436
 16 x .170 x 1 z=36TC (+20) GL1636

GROOVER

8 x 1/4 x 5/8 z=24 G81424
 10 x 1/4 x 5/8 z=24 G101424

MITRE SAW BLADES (ATB W/RAKER)

10 x .110 x 5/8 z=60ATB (-2) MT1060
 10 x .115 x 5/8 z=80ATB (-5) MT1080
 12 x .128 x 5/8 z=100ATB (-5) MT121058
 12 x .110 x 1 z=60ATB (0) MT1260D
 12 x .125 x 1 z=80ATB (-2) MT1280
 12 x .110 x 1 z=80ATB (0) MT1280D
 14 x .150 x 1 z=100ATB (-2) MT1410
 14 x .150 x 5/8 z=100ATB (-2) MT141058
 14 x .150 x 1 z=90ATB (-2) MT1490
 15 x .115 x 1 z=100ATB (-2) MT1510

NON FERROUS

10 x .110 x 5/8 z=60TC NF1060TK

NON FERROUS METAL

8 x .115 x 5/8 z=60TC (-2) NF860
 10 x .124 x 5/8 z=100TC (-5) NF1010
 10 x .115 x 5/8 z=60TC (-2) NF1060
 10 x .124 x 5/8 z=80TC (-5) NF1080
 10 x .102 x 5/8 z=80TC (0) NF1080M
 12 x .128 x 1 z=100TC (-5) NF1210
 12 x .128 x 5/8 z=100TC (-5) NF121058
 12 x .125 x 5/8 z=60TC (-2) NF1260
 12 x .110 x 1 z=80TC (0) NF1280D
 14 x .150 x 5/8 z=100TC (-2) NF141058
 15 x .115 x 1 z=100TC (-2) NF1510
 16 x .150 x 1 z=100TC (-2) NF1610
 18 x .165 x 1 z=100TC (-2) NF1810

PLEX CUT SAW (PLASTICS)

10 x .106 x 5/8 z=80TC45 (+5) PC1080

RADIAL OVERARM SAWS

12 x .135 x 5/8 z=60ATB (-2) RO1260
 16 x .165 x 1 z=40ATB (-2) RO1640
 16 x .155 z 1 z=72ATB (-2) RO1672

SOLID SURFACE BLADES (TC45)

7-1/4 x .104 x univ z=40TC(-2) DFCL71440
 8 x .110 x 5/8 z=60TC (-2) DFCL860
 10 x .110 x 5/8 z=60TC (-2) DFCL1060
 10 x .110 x 5/8 z=80TC (-2) DFCL1080
 12 x .117 x 1 z=100TC (-2) DFCL1210
 220 x .115 x 30 z=64TC (-5) DFCL22064
 250 x .125 x 30 z=80TC (-5) DFCL25080
 300 x .115 x 30 z=100TC (-5) DFCL30010

SPECIAL PURPOSE CUT-OFF

10 x .125 x 5/8 z=80ATB (+5) SPE1080A
 10 x .125 x 5/8 z=80TC (+5) SPE1080T
 12 x .135 x 1 z=100TC (+5) SPE1210T
 12 x .135 x 1 z=80TC (+5) SPE1280T
 14 x .150 x 1 z=100ATB (+5) SPE1410A
 14 x .150 x 1 z=100TC (+5) SPE 1410T
 14 x .150 x 1 z=80TC (+10) SPE 1480T
 16 x .160 x 1 z=100TC (+5) SPE1610T
 16 x .160 x 1 z=120TC (+5) SPE1620T
 16 x .150 x 1 z=80ATB (+10) SPE1680A
 18 x .175 x 1 z=100TC (+10) SPE1810T
 18 x .175 x 1 z=120ATB (+10) SPE1820A
 18 x .175 x 1 z=120TC (+10) SPE1820T
 18 x .175 x 1 z=80TC (+10) SPE1880T
 300 x 3.2 x 30 z=72TC (+10) SPE30072T

STANDARD PURPOSE CUT-OFF

8 x .125 x 5/8 z=60TC (+10) SP860T
 12 x .135 x 1 z=60ATB (+10) SP1260A
 12 x .135 x 1 z=60TC (+10) SP1260T
 14 x .155 x 1 z=60ATB (+10) SP1460A
 14 x .155 x 1 z=60TC (+10) SP1460T
 16 x .155 x 1 z=60TC (+10) SP1660T
 16 x .155 x 1 z=60ATB (+10) SP1660A
 18 x .180 x 1 z=60ATB (+10) SP1860A
 300 x 3.4 x 30 z=60TC (+10) SP30060A

STANDARD PURPOSE CUT-OFF

10 x .125 x 5/8 z=60ATB (+10)
 10 x .125 x 5/8 z=60TC (+10)

STEEL CUTTING BLADES

12 x .088 x 1 z=60
 12 x .088 x 1 z=80
 14 x .088 x 1 z=72

STRAIGHT TOP RIP SAWS

10 x .145 x 5/8 z=24 (+20)
 12 x .160 x 1 z=24 (+20)
 14 x .170 x 1 z=24 (+20)
 16 x .170 x 1 z=36 (+20)
 300 x .125 x 70 z=24 (+20)

THIN RIM SAWS

12 x .092 x 1 z=100ATB (+5)
 12 x .115 x 1 z=100ATB (+5)

THIN KERF SAWS

8 x .102 x 5/8 z=60ATB (+5)
 10 x .102 x 5/8 z=24ATB (+15)
 10 x .102 x 5/8 z=60TC (+10)
 10 x .102 x 5/5 z=60ATB (+10)
 10 x .102 x 5/8 z=80ATB (+10)
 10 x .102 x 5/8 z=80TC (+10)
 12 x .115 x 1 z=80ATB (+5)
 12 x .115 x 1 z=80TC (+5)

SOLID CARBIDE BIT ADAPTERS

15mm dia x 40mm oal

2.0	7000-2.0-APT
2.4 3/32	7000-2.4-APT
2.5	7000-2.5-APT
2.8	7000-2.8-APT
3.0	7000-3.0-APT
3.2 1/8	7000-3.2-APT
3.5	7000-3.5-APT
4.0	7000-4.0-APT
5.0	7000-5.0-APT

10 mm shank dia x 40mm oal



SPLIT ADAPTERS

2.0	7000-2-SPT APT
3.0	7000-3-SPT APT
4.0	7000-4-SPT APT

ADAPTERS W/ 8MM ROUND SK

7000-APT-DRILL

CHUCKS W/ 10MM THREADED SK

7000-ADAPTER-L
7000-ADAPTER-R



SOLID CARBIDE JOBBER V-TIP BITS

	SIZE MM	V-TIP	RH	LH	
20mm cl 45mm oal	2.0	V-TIP	7000-020	00B	01BL
30mm cl 53mm oal	2.4	V-TIP	7000-024	00B	01BL
"	2.5	V-TIP	7000-025	00B	01BL
"	2.8	V-TIP	7000-028	00B	01BL
"	3.0	V-TIP	7000-030	00B	01BL
"	3.2	V-TIP	7000-032	00B	01BL
"	3.5	V-TIP	7000-035	00B	01BL
"	4.0	V-TIP	7000-040	00B	01BL
"	5.0	V-TIP	7000-050	00B	01BL



*shank same diameter as bit

CONE ADAPTERS W/10MM THREADED SK

7000-ADAPTERRC
7000-ADAPTERLC



COUNTERSINK TWIST STYLE

SIZE		RH	LH	LG DIA
4.0	7900-999	04R	04L	16mm
5.0	7900-999	05R	05L	16mm
6.0	7900-999	06R	06L	16mm
7.0	7900-999	07R	07L	16mm
8.0	7900-999	08R	08L	18mm
9.0	7900-999	09R	09L	18mm
10.0	7900-999	10R	10L	20mm
11.0	7900-999	11R	11L	20mm

SOLID CARBIDE DOWEL BITS

	SIZE MM	BP	RH	LH
30mm cl 53mm oal	3.0	BP	7000-030	00BB 01BLB
"	3.2	BP	7000-032	00BB 01BLB
"	3.5	BP	7000-035	00BB 01BLB
"	4.0	BP	7000-040	00BB 01BLB
"	5.0	BP	7000-050	00BB 01BLB

*shank same diameter as bit

COUNTERSINK SHANK STYLE

SIZE		RH	LH	LG DIA
5-10	7900-999	00	01	20mm

DOWEL (BRAD POINT) BITS

57MM OAL, 27MM CL, 10MM SHANK

SIZE MM	BP	RH	LH
4.0 5/32	7000-040	00	01
4.76 3/16	7000-047	00	01
5.0	7000-050	00	01
5.1	7000-051	00	01
5.2	7000-052	00	01
5.5 7/32	7000-055	00	01
6.0	7000-060	00	01
6.35 1/4	7000-635	00	01
6.5	7000-065	00	01
7.0	7000-070	00	01
7.14	7000-071	00	01
7.5	7000-075	00	01
8.0	7000-080	00	01
8.1	7000-081	00	01
8.2	7000-082	00	01
8.5	7000-085	00	01
8.7	7000-087	00	01
9.0	7000-090	00	01
9.52 3/8	7000-375	00	01
10	7000-100	00	01
11	7000-110	00	01
12	7000-120	00	01
12.7 1/2	7000-500	00	01
13	7000-130	00	01
14	7000-140	00	01

LH

RH



SHANK STYLE

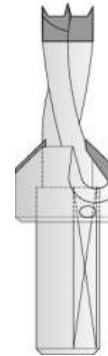

TWIST STYLE



DOWEL BITS 70MM OAL, 35MM CL, 10SK

SIZE MM		RH	LH
* 4.0 5/32	7100-040	10	11
4.76 3/16	7100-047	10	11
* 5.0	7100-050	10	11
5.1	7100-051	10	11
5.2	7100-052	10	11
* 5.5 7/32	7100-055	10	11
* 6.0	7100-060	10	11
* 6.35 1/4	7100-635	10	11
6.5	7100-065	10	11
6.7	7100-067	10	11
* 7.0	7100-070	10	11
7.14 9/32	7100-071	10	11
7.5	7100-075	10	11
* 8.0	7100-080	10	11
8.1	7100-081	10	11
8.2	7100-082	10	11
8.4	7100-084	10	11
8.5	7100-085	10	11
8.73	7100-087	10	11
9.0	7100-090	10	11
9.52 3/8	7100-375	10	11
10.0	7100-100	10	11
10.4	7100-104	10	11
11.0	7100-110	10	11
11.1 7/16	7100-111-1	10	11
12.0	7100-120	10	11
12.7 1/2	7100-500	10	11
13.0	7100-130	10	11
14.0	7100-140	10	11
14.3	7100-143	10	11
15.0	7100-150	10	11
15.9 5/8	7100-159	10	11
16.0	7100-160	10	11
17.0	7100-170	10	11
18.0	7100-180	10	11

77MM OAL 45MM CL RH LH

		RH	LH
4.0	7100-040	20	21
5.0	7100-050	20	21
5.5	7100-055	20	21
6.0	7100-060	20	21
6.35	7100-635	20	21
6.5	7100-065	20	21
7.0	7100-070	20	21
7.14 9/32	7100-071	20	21
8.0	7100-080	20	21
8.2	7100-082	20	21
9.0	7100-090	20	21
9.52 3/8	7100-375	20	21
10.0	7100-100	20	21
11.0	7100-110	20	21
12.0	7100-120	20	21

85MM OAL 50MM CL RH LH

		RH	LH
5.0	7100-050	30	31
8.0	7100-080	30	31

AYEN BITS WITH 10MM THREADED SHANK

BRAD POINT 43MM CL RH LH

		RH	LH
5.0	7000-050	43	43L
6.0	7000-060	43	43L
8.0	7000-080	43	43L
10.0	7000-100	43	43L

THRU BORE 43MM CL RH LH

		RH	LH
5.0	7400-050	43R	43L
8.0	7400-080	43R	43L

AYEN BITS WITH 8MM THREADED SHANK

		43-8	43-L-8
5.0	7000-050	43-8	43-L-8
8.0	7000-080	43-8	43-L-8



THRU-BORE (V-POINT) 58MM OAL, 35MM CL, 10SK

SIZE MM		RH	LH
4.0 5/32	7300-040	20	21
4.76	7300-047	20	21
5.0	7300-050	20	21
5.2	7300-052	20	21
6.0	7300-060	20	21
6.35 1/4	7300-635	20	21
6.5	7300-065	20	21
7.0	7300-070	20	21
8.0	7300-080	20	21
9.0	7300-090	20	21
10.0	7300-100	20	21
11.0	7300-110	20	21
12.0	7300-120	20	21

70MM OAL 47MM CL RH LH

		RH	LH
4.0 5/32	7400-040	30	31
4.7 3/16	7400-047	30	31
5.0	7400-050	30	31
5.1	7400-051	30	31
5.2	7400-052	30	31
5.5 7/32	7400-055	30	31
6.0	7400-060	30	31
6.35 1/4	7400-635	30	31
6.5	7400-065	30	31
6.7	7400-067	30	31
7.0	7400-070	30	31
7.14 9/32	7400-071	30	31
7.5	7400-075	30	31
8.0	7400-080	30	31
8.1	7400-081	30	31
8.2	7400-082	30	31
8.5	7400-085	30	31
8.7	7400-087	30	31
9.0	7400-090	30	31
9.52 3/8	7400-375	30	31
10.0	7400-100	30	31
10.4	7400-104	30	31
11.0	7400-110	30	31
11.1 7/16	7400-111	30	31
12.0	7400-120	30	31
12.7 1/2	7400-500	30	31
13.0	7400-130	30	31
14.0	7400-140	30	31
15.0	7400-150	30	31
16.0	7400-160	30	31
16.5	7400-165	30	31
17.0	7400-170	30	31
18.0	7400-180	30	31
19.0	7400-190	30	31
20.0	7400-200	30	31

77MM OAL 54MM CL RH LH

		RH	LH
4.0	7400-040	77R	77L
5.0	7400-050	77R	77L
5.5	7400-055	77R	77L
6.0	7400-060	77R	77L
6.35	7400-635	77R	77L
7.0	7400-070	77R	77L
7.1	7400-071	77R	77L
8.0	7400-080	77R	77L
8.2	7400-082	77R	77L
9.0	7400-090	77R	77L
9.52 3/8"	7400-375	77R	77L
10.0	7400-100	77R	77L
11.1	7400-111	77R	77L
12.0	7400-120	77R	77L
12.7 1/2	7400-500	77R	77L

HINGE BITS 57MM OAL

<u>57 MM</u>		<u>RH</u>	<u>LH</u>
14.3	7500-143	00	01
15	7500-150	00	01
16	7500-160	00	01
16.5	7500-165	00	01
18	7500-180	00	01
19	7500-190	00	01
19.7	7500-197	00	01
20	7500-200	00	01
22	7500-220	00	01
24	7500-240	00	01
25	7500-250	00	01
26	7500-260	00	01
27	7500-270	00	01
28	7500-280	00	01
30	7500-300	00	01
32	7500-320	00	01
35	7500-350	00	01
38	7500-380	00	01
40	7500-400	00	01
44	7500-440	00	01
55	7500-550	00	01
58	7500-580	00	01
<u>70 MM</u>		<u>RH</u>	<u>LH</u>
14.3 9/16	7500-143	10	11
15	7500-150	10	11
16	7500-160	10	11
16.5	7500-165	10	11
18	7500-180	10	11
19.0 3/4	7500-190	10	11
20	7500-200	10	11
22	7500-220	10	11
25	7500-250	10	11
26	7500-260	10	11
28	7500-280	10	11
28.6 1 1/8	7500-286	10	11
30	7500-300	10	11
35	7500-350	10	11
38	7500-380	10	11
40	7500-400	10	11
44	7500-440	10	11
45	7500-450	10	11
<u>3-WING 57MM OAL</u>		<u>RH</u>	<u>LH</u>
35	7500-350	20	21
40	7500-400	20	21



SOLID CARBIDE BITS DOWEL STYLE (BRAD POINT)

<u>57 MM</u>		<u>RH</u>	<u>LH</u>
3.0	7000-030	00SC	01SC
3.2	7000-032	00SC	01SC
4.0	7000-040	00SC	01SC
5.0	7000-050	00SC	01SC
6.0	7000-060	00SC	01SC
6.35 1/4"	7000-635	00SC	01SC
7.0	7000-070	00SC	01SC
8.0	7000-080	00SC	01SC
8.2	7000-082	00SC	01SC
10.0	7000-100	00SC	01SC
<u>70 MM</u>			
3.0	7100-030	10SC	11SC
3.2	7100-032	10SC	11SC
3.5	7100-035	10SC	11SC
4.0	7100-040	10SC	11SC
5.0	7100-050	10SC	11SC
6.0	7100-060	10SC	11SC
6.35 1/4"	7100-635	10SC	11SC
6.5	7100-065	10SC	11SC
7.0	7100-070	10SC	11SC
8.0	7100-080	10SC	11SC
8.2	7100-082	10SC	11SC
10.0	7100-100	10SC	11SC

THRU BORE STYLE (V-POINT)

<u>58 MM</u>		<u>RH</u>	<u>LH</u>
3.0	7300-030	20SC	21SC
3.2	7300-032	20SC	21SC
5.0	7300-050	20SC	21SC
8.0	7300-080	20SC	21SC
<u>70 MM</u>			
3.0	7400-030	30SC	31SC
3.2	7400-032	30SC	31SC
3.5	7400-035	30SC	31SC
4.0	7400-040	30SC	31SC
5.0	7400-050	30SC	31SC
6.0	7400-060	30SC	31SC
6.35 1/4"	7400-635	30SC	31SC
6.5	7400-065	30SC	31SC
7.0	7400-070	30SC	31SC
8.0	7400-080	30SC	31SC
9.0	7400-090	30SC	31SC
10.0	7400-100	30SC	31SC
<u>77 MM</u>			
5.0	7400-050	77RSC	77LSC



Boring Bits with Special Size Shanks



* All Bits have 7/16-14 Threaded Shank. HSS Part # start with 9000-, CT Part#'s start with 9100-

Part#	Description	Drill Size	Twist Length	OAL	SK
9000-047-7/16R	7/16-14 Threaded SK Brad Pt	4.76 (3/16")	76.2 (3")	114.3 (4 1/2")	7/16-14Thread
9000-635-7/16R	7/16-14 Threaded SK Brad Pt	6.35 (1/4")	76.2 (3")	114.3 (4 1/2")	7/16-14Thread
9000-079-7/16R	7/16-14 Threaded SK Brad Pt	7.94 (5/16")	76.2 (3")	114.3 (4 1/2")	7/16-14Thread
9000-375-7/16R	7/16-14 Threaded SK Brad Pt	9.52 (3/8")	76.2 (3")	114.3 (4 1/2")	7/16-14Thread
9000-500-7/16R	7/16-14 Threaded SK Brad Pt	12.7 (1/2")	76.2 (3")	114.3 (4 1/2")	7/16-14Thread
9000-158-7/16R	7/16-14 Threaded SK Brad Pt	15.87 (5/8")	76.2 (3")	114.3 (4 1/2")	7/16-14Thread
9000-750-7/16R	7/16-14 Threaded SK Brad Pt	19.05 (3/4")	76.2 (3")	114.3 (4 1/2")	7/16-14Thread



*All Bits have a 7/16-14 Threaded Shank. HSS Part # start with 9300-, CT Part#'s start with 9400-

Part#	Description	Drill Size	Twist Length	OAL	SK
9300-047-7/15R	7/16-14 Threaded SK Thru-Bore	4.76 (3/16")	76.2 (3")	114.3 (4 1/2")	7/16-14Thread
9300-635-7/16R	7/16-14 Threaded SK Thru-Bore	6.35 (1/4")	76.2 (3")	114.3 (4 1/2")	7/16-14Thread
9300-079-7/16R	7/16-14 Threaded SK Thru-Bore	7.94 (5/16")	76.2 (3")	114.3 (4 1/2")	7/16-14Thread
9300-375-7/16R	7/16-14 Threaded SK Thru-Bore	9.52 (3/8")	76.2 (3")	114.3 (4 1/2")	7/16-14Thread
9300-500-7/16R	7/16-14 Threaded SK Thru-Bore	12.7 (1/2")	76.2 (3")	114.3 (4 1/2")	7/16-14Thread
9300-158-7/16R	7/16-14 Threaded SK Thru-Bore	15.87 (5/8")	76.2 (3")	114.3 (4 1/2")	7/16-14Thread
9300-750-7/16R	7/16-14 Threaded SK Thru-Bore	19.05 (3/4")	76.2 (3")	114.3 (4 1/2")	7/16-14Thread



All Drills have 12.7 X 50.8 Shank available in Counterbore and Countersink. HSS Part # start with 9000-, CT Part#'s start with 9100-

Part#	Description	Coore Size	Drill Size	Cut length	OAL
9000-032-375-CBR	1/2" X 2 ADJ. Cbore	9.52 (3/8")	3.2 (1/8")	63.5 (2.5)	114.3 (4 1/2")
9000-032-375-CSR	1/2" X 2 ADJ. Csink	9.52 (3/8")	3.2 (1/8")	63.5 (2.5)	114.3 (4 1/2")
9000-397-375-CBR	1/2" X 2 ADJ. Cbore	9.52 (3/8")	3.97 (5/32")	63.5 (2.5)	114.3 (4 1/2")
9000-397-375-CSR	1/2" X 2 ADJ. Csink	9.52 (3/8")	3.97 (5/32")	63.5 (2.5)	114.3 (4 1/2")
9000-047-375-CBR	1/2" X 2 ADJ. Cbore	9.52 (3/8")	4.76 (3/16")	63.5 (2.5)	114.3 (4 1/2")
9000-047-375-CSR	1/2" X 2 ADJ. Csink	9.52 (3/8")	4.76 (3/16")	63.5 (2.5)	114.3 (4 1/2")
9000-047-111-CBR	1/2" X 2 ADJ. Cbore	11.11 (7/16")	4.76 (3/16")	63.5 (2.5)	114.3 (4 1/2")
9000-047-111-CSR	1/2" X 2 ADJ. Csink	11.11 (7/16")	4.76 (3/16")	63.5 (2.5)	114.3 (4 1/2")
9000-055-111-CBR	1/2" X 2 ADJ. Cbore	11.11 (7/16")	5.55 (7/32")	63.5 (2.5)	114.3 (4 1/2")
9000-055-111-CSR	1/2" X 2 ADJ. Csink	11.11 (7/16")	5.55 (7/32")	63.5 (2.5)	114.3 (4 1/2")
9000-032-500-CBR	1/2" X 2 ADJ. Cbore	12.7 (1/2")	3.2 (1/8")	63.5 (2.5)	114.3 (4 1/2")
9000-032-500-CSR	1/2" X 2 ADJ. Csink	12.7 (1/2")	3.2 (1/8")	63.5 (2.5)	114.3 (4 1/2")
9000-039-500-CBR	1/2" X 2 ADJ. Cbore	12.7 (1/2")	3.97 (5/32")	63.5 (2.5)	114.3 (4 1/2")
9000-039-500-CSR	1/2" X 2 ADJ. Csink	12.7 (1/2")	3.97 (5/32")	63.5 (2.5)	114.3 (4 1/2")
9000-047-500-CBR	1/2" X 2 ADJ. Cbore	12.7 (1/2")	4.76 (3/16")	63.5 (2.5)	114.3 (4 1/2")
9000-047-500-CSR	1/2" X 2 ADJ. Csink	12.7 (1/2")	4.76 (3/16")	63.5 (2.5)	114.3 (4 1/2")
9000-055-500-CBR	1/2" X 2 ADJ. Cbore	12.7 (1/2")	5.55 (7/32")	63.5 (2.5)	114.3 (4 1/2")
9000-055-500-CSR	1/2" X 2 ADJ. Csink	12.7 (1/2")	5.55 (7/32")	63.5 (2.5)	114.3 (4 1/2")
9000-635-500-CBR	1/2" X 2 ADJ. Cbore	12.7 (1/2")	6.35 (1/4")	63.5 (2.5)	114.3 (4 1/2")
9000-635-500-CSR	1/2" X 2 ADJ. Csink	12.7 (1/2")	6.35 (1/4")	63.5 (2.5)	114.3 (4 1/2")
9000-047-158-CBR	1/2" X 2 ADJ. Cbore	15.87 (5/8")	4.76 (3/16")	63.5 (2.5)	114.3 (4 1/2")
9000-047-158-CSR	1/2" X 2 ADJ. Csink	15.87 (5/8")	4.76 (3/16")	63.5 (2.5)	114.3 (4 1/2")
9000-635-158-CBR	1/2" X 2 ADJ. Cbore	15.87 (5/8")	6.35 (1/4")	63.5 (2.5)	114.3 (4 1/2")
9000-635-158-CSR	1/2" X 2 ADJ. Csink	15.87 (5/8")	6.35 (1/4")	63.5 (2.5)	114.3 (4 1/2")
9000-071-158-CBR	1/2" X 2 ADJ. Cbore	15.87 (5/8")	7.14 (9/32")	63.5 (2.5)	114.3 (4 1/2")
9000-071-158-CSR	1/2" X 2 ADJ. Csink	15.87 (5/8")	7.14 (9/32")	63.5 (2.5)	114.3 (4 1/2")
9000-079-158-CBR	1/2" X 2 ADJ. Cbore	15.87 (5/8")	7.94 (5/16")	63.5 (2.5)	114.3 (4 1/2")
9000-079-158-CSR	1/2" X 2 ADJ. Csink	15.87 (5/8")	7.94 (5/16")	63.5 (2.5)	114.3 (4 1/2")
9000-047-750-CBR	1/2" X 2 ADJ. Cbore	19.05 (3/4")	4.76 (3/16")	63.5 (2.5)	114.3 (4 1/2")
9000-047-750-CSR	1/2" X 2 ADJ. Csink	19.05 (3/4")	4.76 (3/16")	63.5 (2.5)	114.3 (4 1/2")

Boring Bits with Special Size Shanks



9000-635-750-CBR	1/2" X 2 ADJ. Cbore	19.05 (3/4")	6.35 (1/4")	63.5 (2.5)	114.3 (4 1/2")
9000-635-750-CSR	1/2" X 2 ADJ. Csink	19.05 (3/4")	6.35 (1/4")	63.5 (2.5)	114.3 (4 1/2")
9000-071-750-CBR	1/2" X 2 ADJ. Cbore	19.05 (3/4")	7.14 (9/32")	63.5 (2.5)	114.3 (4 1/2")
9000-071-750-CSR	1/2" X 2 ADJ. Csink	19.05 (3/4")	7.14 (9/32")	63.5 (2.5)	114.3 (4 1/2")
9000-079-750-CBR	1/2" X 2 ADJ. Cbore	19.05 (3/4")	7.94 (5/16")	63.5 (2.5)	114.3 (4 1/2")
9000-079-750-CSR	1/2" X 2 ADJ. Csink	19.05 (3/4")	7.94 (5/16")	63.5 (2.5)	114.3 (4 1/2")
9000-375-750-CBR	1/2" X 2 ADJ. Cbore	19.05 (3/4")	9.52 (3/8")	63.5 (2.5)	114.3 (4 1/2")
9000-375-750-CSR	1/2" X 2 ADJ. Csink	19.05 (3/4")	9.52 (3/8")	63.5 (2.5)	114.3 (4 1/2")



All Counterbore and Countersinks have 7/16-14 Threaded Shank. HSS Part # start with 9000-, CT Part#'s start with 9100-

Part#	Description	Cbore Size	Drill Size	Cut length	OAL
9000-047-375-716CBR	7/16-14 Thread Cbore	9.52 (3/8")	4.76 (3/16")	76.2 (3")	114.3 (4 1/2")
9000-047-375-716CSR	7/16-14 Thread Csink	9.52 (3/8")	4.76 (3/16")	76.2 (3")	114.3 (4 1/2")
9000-047-500-716CBR	7/16-14 Thread Cbore	12.7 (1/2")	4.76 (3/16")	76.2 (3")	114.3 (4 1/2")
9000-047-500-716CSR	7/16-14 Thread Csink	12.7 (1/2")	4.76 (3/16")	76.2 (3")	114.3 (4 1/2")
9000-055-500-716CBR	7/16-14 Thread Cbore	12.7 (1/2")	5.55 (9/32")	76.2 (3")	114.3 (4 1/2")
9000-055-500-716CSR	7/16-14 Thread Csink	12.7 (1/2")	5.55 (9/32")	76.2 (3")	114.3 (4 1/2")
9000-635-500-716CBR	7/16-14 Thread Cbore	12.7 (1/2")	6.35 (1/4")	76.2 (3")	114.3 (4 1/2")
9000-635-500-716CST	7/16-14 Thread Csink	12.7 (1/2")	6.35 (1/4")	76.2 (3")	114.3 (4 1/2")



6" OAL HSS Straight Shank Centerdrills - No flat

Part#	Description	Drill Diameter	Twist Length	OAL	Shank Size
9000-032-152RST		3.2 (1/8")	57.15 (2 1/4")	152.4 (6")	3.2 (1/8")
9000-039-152RST		3.97 (5/32")	57.15 (2 1/4")	152.4 (6")	3.97 (5/32")
9000-047-152RST		4.76 (3/16")	57.15 (2 1/4")	152.4 (6")	4.76 (3/16")
9000-055-152RST		5.55 (7/32")	57.15 (2 1/4")	152.4 (6")	5.55 (7/32")
9000-635-152RST		6.35 (1/4")	57.15 (2 1/4")	152.4 (6")	6.35 (1/4")
9000-071-152RST		7.14 (9/32")	57.15 (2 1/4")	152.4 (6")	7.14 (9/32")
9000-079-152RST		7.94 (5/16")	57.15 (2 1/4")	152.4 (6")	7.94 (5/16")
9000-375-152RST		9.52 (3/8")	57.15 (2 1/4")	152.4 (6")	9.52 (3/8")



*All Drills Have Shank of 1/2" X 2"

Part#	Description	Drill Diameter	Twist Length	OAL	Shank
9000-047-127R	Brad Point Drill, 1/2" X 2"	4.76 (3/16)	76.2 (3")	127 (5")	12.7 (1/2")
9000-635-127R	Brad Point Drill, 1/2" X 2"	6.35 (1/4")	76.2 (3")	127 (5")	12.7 (1/2")
9000-714-127R	Brad Point Drill, 1/2" X 2"	7.14 (9/32")	76.2 (3")	127 (5")	12.7 (1/2")
9000-794-127R	Brad Point Drill, 1/2" X 2"	7.94 (5/16)	76.2 (3")	127 (5")	12.7 (1/2")
9000-952-127R	Brad Point Drill, 1/2" X 2"	9.52 (3/8")	76.2 (3")	127 (5")	12.7 (1/2")
9000-111-127R	Brad Point Drill, 1/2" X 2"	11.11 (7/16")	76.2 (3")	127 (5")	12.7 (1/2")
9000-127-127R	Brad Point Drill, 1/2" X 2"	12.7 (1/2")	76.2 (3")	127 (5")	12.7 (1/2")

**If not in stock, please allow for 3 week delivery *Other Sizes available, Call for pricing

Custom Made 2-step Counterbore and Countersink Bits

Thru-Bore Counterbore

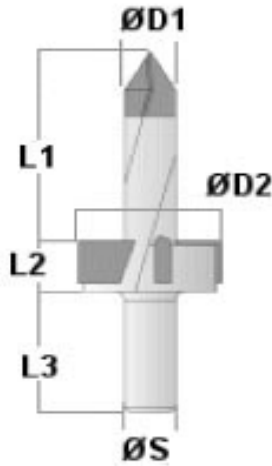

ØS	
ØD1	
ØD2	
L1	
L2	
L3	

Thru-Bore Countersink

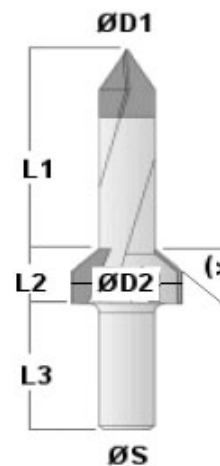

ØS	
ØD1	
ØD2	
L1	
L2	
L3	
<)	

Brad Point Counterbore

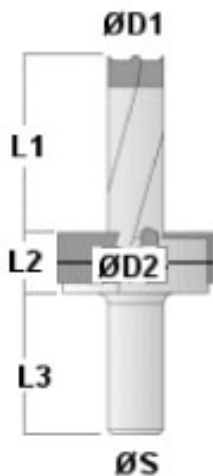

ØS	
ØD1	
ØD2	
L1	
L2	
L3	

Brad Point Countersink

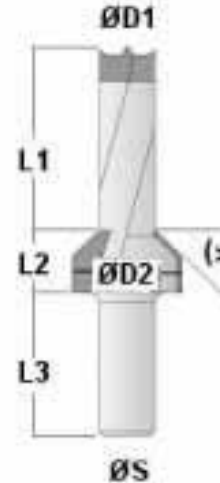

ØS	
ØD1	
ØD2	
L1	
L2	
L3	
<)	

These bits are custom made to your specifications
 6pc Minimum order per rotation
 3 Week Delivery

8MM SHANK DOWEL BITS

55MM OAL		<u>RH</u>	<u>LH</u>
4.0	7200-040	00	01
5.0	7200-050	00	01
6.0	7200-060	00	01
6.35 1/4"	7200-635	00	01
7.0	7200-070	00	01
8.0	7200-080	00	01
8.2	7200-082	00	01
8.7	7200-087	00	01
10.0	7200-100	00	01
12.7 1/2"	7200-500	00	01
67MM OAL			
5.0	7200-050	8R	8L
6.0	7200-060	8R	8L
6.35 1/4"	7200-635	8R	8L
7.0	7200-070	8R	8L
8.0	7200-080	8R	8L
8.2	7200-082	8R	8L
10.0	7200-100	8R	8L

8MM SHANK THRU-BORE BITS

57 MM OAL		<u>RH</u>	<u>LH</u>
5.0	7600-050	40	41
7.0	7600-070	40	41
8.0	7600-080	40	41
8.7	7600-087	40	41
70 MM OAL			
5.0	7700-050	50	51
7.0	7700-070	50	51
8.0	7700-080	50	51
77MM OAL			
5.0	7700-050	77R	77L
7.0	7700-070	77R	77L

HAFELE SYSTEM BORING BITS

UNITOOL DRILLING JIG BITS W/ 9MM RD SK

12 X 139 BP CT	001.24.489
15 X 139 BP CT	001.24.443
20 X 139 BP CT	001.24.425

RAFIX SE HOUSING BITS

20 X 12.7 X 57	001.24.309 R
20 X 12.7 X 70	001.24.340
22 X 12.7 X 57	001.24.327 R
22 X 12.7 X 57 LH	001.24.337 L

FLYCUTTER/SPOILBOARD

INSERT TOOLING

2-1/2" x 14 x 1/2" SK 2-Wing	1000-21/2-14
4" x 14 x 3/4" SK 3-Wing	1000-4"-14

REPLACEMENT INSERT

14 x 14 x 2	5300-014-14
-------------	-------------

SCREWS FOR FLYCUTTER/SPOILBOARD

4"-14 FC INSERT SCREW	1000-SCREW-C
4"-14 FC ALIGN SCREW	1000-SCREW-D

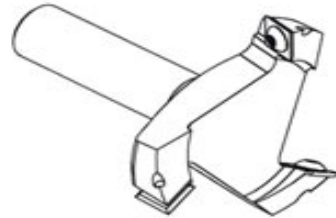

GRASS AMERICA BITS

10 x 10.2 x 12 x 55.5 RH CP CS	7000-GRASS-00
10 x 10.2 x 12 x 55.5 LH CP CS	7000-GRASS-01

CONFIRMAT 3-STEP DRILL BITS

5 X 7 X 10 X 150 HSS	7000-5/7/10/R (001.22.645)
5 X 7 X 10 X 150 CT	7000-5/7/10/CT (001.22.645)
4 X 5 X 8 X 148.5 HSS	7000-4/5/8/148 (001.22.663)



DIAMOND ROUTER BITS

3/8 x 1" x 1/2 x 1+1	8000-3/8-1"
1/2 x 1 x 1/2 x 3	8000-1/2-1
1/2 x 1-3/8 x 1/2 x 3-5/8	8000-1/2-1 3/8
3/4 x 1-5/8 x 3/4 x 3-1/2	8000-3/4-1 5/8
5/8 x 1-5/8 x 5/8 x 3-1/2	8000-5/8-1 5/8

INSERT ROUTER BITS 1/2" SK

1/2" x 30MM x 2 3/4	3000-BITS-1/2
5/8" x 30MM x 3 5/32	3000-BITS-5/8
5/8" x 50MM x 3 11/16	3000-BITS-5/8A
1/2" x 30 RB SCREW	3000-1/2-30M
5/8" x 30 RB SCREW	3000-5/8-30M
5/8" x 50 RB SCREW	3000-5/8-50M

2-SIDED STRAIGHT INSERTS

DIMENSION

- 6.0 x 12 x 1.5
- 7.5 x 12 x 1.5
- 8.6 x 12 x 1.5
- 9.0 x 12 x 1.5
- 9.6 x 12 x 1.5
- 10 x 12 x 1.5
- 10.5 x 12 x 1.5
- 13 x 12 x 1.5
- 15 x 12 x 1.5
- 18 x 12 x 1.5
- 20 x 12 x 1.5
- 20 x 14.3 x 2.5
- 24.7 x 12 x 1.5
- 25 x 12 x 1.5
- 25 x 12 x 1.5
- 30 x 12 x 1.5
- 30 x 12 x 2.5
- 40 x 12 x 1.5
- 45 x 12 x 1.5
- 50 x 12 x 1.5
- 60 x 12 x 1.5
- 80 x 13 x 2.2
- 100 x 13 x 2.2
- 120 x 13 x 2.2

STANDARD GRADE

- 5000-006-00
- 5000-075-00
- 5000-086-00
- 5000-090-00
- 5000-096-00
- 5000-010-00
- 5000-105-00
- 5000-013-00
- 5000-015-00
- 5000-018-00
- 5000-020-00
- 5000-020-14
- 5000-247-00
- 5000-025-00 1H
- 5000-025-00 2H
- 5000-030-00
- 5000-030-00-25
- 5000-040-00
- 5000-045-00
- 5000-050-00
- 5000-060-00
- 5000-080-00
- 5000-100-00
- 5000-120-00

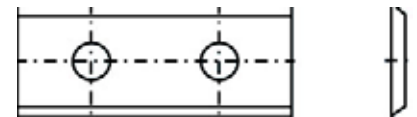
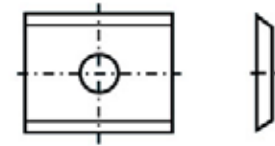

4-SIDED STRAIGHT INSERTS

DIMENSION

- 10.5 x 10.5 x 1.5
- 10.5 x 10.5 x 1.5 CS HOLE
- 12 x 12 x 1.5
- 13 x 13 x 2.5 6MM CS HOLE
- 13 x 13 x 2.5 4MM HOLE
- 13.6 x 13.6 x 2
- 14 x 14 x 1.2
- 14 x 14 x 1.2 HOLZHER
- 14 x 14 x 1.7
- 14 x 14 x 2.0
- 14 x 14 x 2.0 R=0.5
- 14.3 x 14.3 x 2.5
- 14.6 x 14.6 x 2.5
- 15 x 15 x 2.0 CHIP BRKR
- 15 x 15 x 2.5
- 17 x 17 x 2.0 3MM HOLE
- 17 x 17 x 2.0 4MM HOLE
- 20 x 12 x 1.5
- 30 x 12 x 1.5
- 40 x 12 x 1.5
- 50 x 12 x 1.5
- 50 x 12 x 1.7 3 HOLE
- 30 x 9 x 1.5

STANDARD GRADE

- 5300-010-10
- 5300-105-10
- 5300-012-12
- 5300-013-13
- 5300-013-13-4
- 5300-136-13
- 5300-014-12
- 5300-014-12-1
- 5300-014-17
- 5300-014-14
- 5300-014-14R
- 5300-143-14
- 5300-146-14
- 5300-015-15
- 5300-015-25
- 5300-017-17-3
- 5300-017-17
- 5300-020-20
- 5300-030-30
- 5300-040-40
- 5300-050-50
- 5300-050-50-3
- 5300-030-09-04



SKREW SIDE INSERTS (5-DEGREE ANGLE)

- 20 x 12 x 1.5



- 30 x 12 x 1.5

- 50 x 12 x 1.5

BEVEL INSERTS (HOLZ-HER STYLE)

- 30 x 12 x 1.5

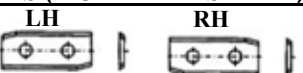

- 50 x 12 x 1.5

OPPOLD INSERT

- 44.5 x 15 x 1.5

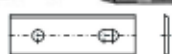

RH

- 5100-020-R
- 5100-030-R
- 5100-050-R

RH

- 5200-295-R
- 5200-050-R

- 5000-044-15

RADIUS INSERTS

(SYSTEM HOMAG/IMA)

12 X 12 X 1.5 R=2 5700-012-2
 12 X 12 X 1.5 R=3 5700-012-3
 12 X 12 X 1.5 R=4 5700-012-4

13 X 16 X 2 R=2 5600-013-16-2
 13 X 16 X 2 R=3 5600-013-16-3
 13 X 16 X 2 R=4 5600-013-16-4

15 X 14.5 X 2 LH R=3 5600-015-145L
 15 X 14.5 X 2 RH R=3 5600-015-145R
 16.1 X 14 X 12 LH R=3 5600-161-14-L3
 16.1 X 14 X 12 RH R=3 5600-161-14-R3
 16.1 X 14 X 12 LH R=2 5600-161-14L2
 16.1 X 14 X 12 RH R=2 5600-161-14R2

16 X 14 X 2 R=3 5600-016-14-3
 16 X 17.5 X 2 R=2 5600-016-02
 16 X 17.5 X 2 R=3 5600-016-03
 16 X 17.5 X 2 R=4 5600-016-04
 16 X 17.5 X 2 R=5 5600-016-05
 16 X 17.5 X 2 D=3.5 R=5 5600-016-05 35
 16 X 17.5 X 2 D=4.4 R=2 5600-016-02 44
 16 X 17.5 X 2 D=4.4 R=3 5600-016-03 44
 16 X 17.5 X 2 D=3.5 R=4 5600-016-04 35

12 X 14.5 X 2 LH R=2 5600-12-145-L2
 12 X 14.5 X 2 RH R=2 5600-12-145-R2
 12 X 14.5 X 2 LH R=3 5600-12-145-L3
 12 X 14.5 X 2 RH R=3 5600-12-145-R3
 12 X 17 X 2 LH R=3 5600-012-17L
 12 X 17 X 2 RH R=3 5600-012-17R
 19.6 X 15.2 X 2 LH LH R=3 5600-196-15L3
 19.6 X 15.2 X 2 RH RH R=3 5600-196-15R3
 19.6 X 15.2 X 2 LH LH R=2 5600-196-15L2
 19.6 X 15.2 X 2 RH RH R=2 5600-196-15R2

20 X 16 X 2 LH LH R=3 5600-020-16-L3
 20 X 16 X 2 RH RH R=3 5600-020-16-R3

22.3 X 14 X 2 LH LH R=3 5600-22.3-14L
 22.3 X 14 X 2 RH RH R=3 5600-22.3-14R

30 X 14 X 2 LH LH R=3 5600-030-14-L3
 30 X 14 X 2 RH RH R=3 5600-030-14-R3

SCRAPER KNIVES

12.7 X 12.7 X 3.2 R=3 5600-127-03
 20 X 12 X 2 R=2 5000-020-02
 20 X 12 X 2 R=3 5000-020-03
 20 X 12 X 2 R=5 5000-020-05

LAMELLO INSERTS

18 X 18 X 1.95 5800-180-02
 18 X 18 X 2.45 5800-180-245
 18 X 18 X 2.95 5800-180-295
 18 X 18 X 3.70 5800-180-37

OERTLI INSERTS

15 X 8 X 1.5 5500-015-08-O
 32 X 8 X 1.5 5500-032-08-O
 50 X 8 X 1.5 5500-050-08-O

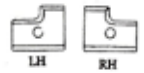
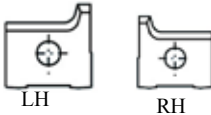
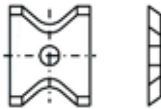

FACE OR BACK GROOVE INSERTS

FACE GROOVE 2-SIDED

7.70 x 8 x 1.5 5500-077-08
 9.70 x 8 x 1.5 5500-097-08
 14.7 x 8 x 1.5 5500-014-08
 30.0 x 8 x 1.5 5500-030-08
 40.0 x 8 x 1.5 5500-040-08
 50.0 x 8 x 1.5 5500-050-08
 50.0 x 8 x 1.5 4-sides 5500-050-08-4
 60.0 x 8 x 1.5 5500-060-08
 12 x 5.5 x 1.1 5500-012-55
 20 x 5.5 x 1.1 5500-020-55
 30 x 5.5 x 1.1 5500-030-55
 35 x 5.5 x 1.1 5500-035-55
 40 x 5.5 x 1.1 5500-040-55
 50 x 5.5 x 1.1 5500-050-55

FACE GROOVE 4-SIDED

20 x 5.5 x 1.1 5500-020-55-4
 30 x 5.5 x 1.1 5500-030-55-4
 35 x 5.5 x 1.1 5500-035-55-4
 40 x 5.5 x 1.1 5500-040-55-4
 50 x 5.5 x 1.1 5500-050-55-4

BACK GROOVE 2-SIDED

12 x 5.5 x 1.1 5900-012-55
 20 x 5.5 x 1.1 5900-020-55
 30 x 5.5 x 1.1 5900-030-55
 40 x 5.5 x 1.1 5900-040-55
 50 x 5.5 x 1.1 5900-050-55
 56 x 5.5 x 1.1 5900-056-55

BACK GROOVE 4-SIDED

20 x 5.5 x 1.1 5900-020-55-4
 30 x 5.5 x 1.1 5900-030-55-4
 40 x 5.5 x 1.1 5900-040-55-4
 50 x 5.5 x 1.1 5900-050-55-4

BACK GROOVE+CENTER NOTCH 4-SIDED LEITZ STYLE

20 x 4.1 x 1.1 5900-020-41
 20 x 5.5 x 1.1 5900-200-55-4
 25 x 5.5 x 1.1 5900-250-55-4
 30 x 5.5 x 1.1 5900-300-55-4
 40 x 5.5 x 1.1 5900-400-55-4
 50 x 5.5 x 1.1 5900-500-55-4

ROUTER BIT 4-SIDED

30 x 9 x 1.5 5500-030-09-4
 40 x 9 x 1.5 5500-040-09-4
 50 x 9 x 1.5 5500-050-09-4

TRIANGLE SPUR INSERTS

22 X 19 X 2 5700-022-19

SPUR FOR ROUTER BIT

18 X 5.7 X 3.5 5000-180-5735

MAKITA INSERTS

82 X 5.5 X 1.1 5900-082-55

3 Sided Inserts

28x7x1.5 5500-280-07

01 MAN-MADE MATERIAL



5500-050-08P



5500-035-55-4P



5900-020-55-4P

5900-050-55-4P



5900-300-55-4P

5900-500-55-4P

5500-030-09-4P

5500-050-09-4P



CNC TOOL HOLDERS & COLLETS

ITEM #	COLLET	D	A	N
HSK-6370	ER32	63	70	50
HSK-6376	ER40	63	76	63
HSK-6380 (SYOZ)	SYOZ25	63	80	63

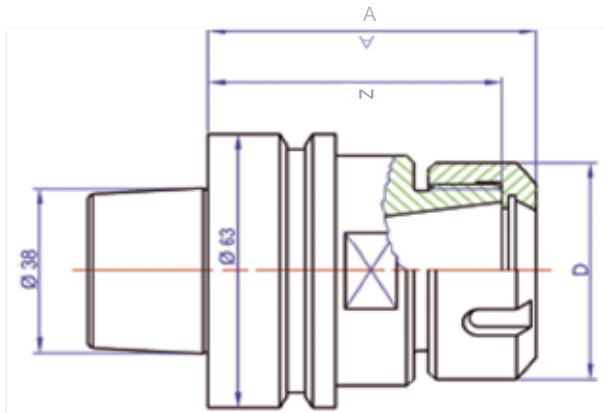

COLLET MEASURING GUIDE

COLLET STYLE	LENGTH "L"	OD "D"
ER11	18MM	11.5MM
ER16	27.5MM	17MM
ER20	31.5MM	21MM
ER25	34MM	26MM
ER32	40MM	33MM
ER40	46MM	41MM
ER50	60MM	52MM
SYOZ25	52MM	35MM

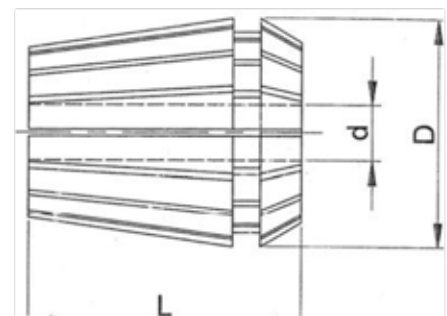

Wrenches

HSK-6370 Wrench

HSK-6376 Wrench

HSK-6380 Wrench (Syoz)

SOLID CARBIDE SPIRALS, UP & DOWN SHEAR



SC SPIRAL 2-FLUTE FINISHER

UPCUT#	DOWNCUT #
SCSU-100	SCSD-200 1/8 x 1/2 x 2 x 1/4
SCSU-101	SCSD-201 5/32 x 5/8 x 2 x 1/4
SCSU-102	SCSD-202 3/16 x 3/4 x 2-1/2 x 1/4
SCSU-104	SCSD-204 1/4 x 3/4 x 2-1/2 x 1/4
SCSU-105	SCSD-205 1/4 x 1 x 2-1/2 x 1/4
SCSU-106	SCSD-206 5/16 x 1 x 2-1/2 x 5/16
SCSU-106A	SCSD-206A 5/16 x 1 x 3 x 1/2
SCSU-107	SCSD-207 7/16 x 1-1/4 x 3 x 1/2
*SCSU-108	SCSD-208 3/8 x 1 x 2-1/2 x 3/8
*SCSU-108A	SCSD-208A 3/8 x 1-1/4 x 3 x 3/8
*SCSU-111	SCSD-211 1/2 x 1-1/4 x 3 x 1/2
*SCSU-112	SCSD-212 1/2 x 1-1/2 x 3-1/2 x 1/2
*SCSU-113	SCSD-213 1/2 x 2 x 4 x 1/2
SCSU-114	SCSD-214 5/8 x 1-1/2 x 3-1/2 x 5/8
SCSU-115	SCSD-215 5/8 x 2 x 4 x 5/8
SCSU-117	SCSD-217 3/4 x 2 x 4 x 3/4
SCSU-118	SCSD-218 3/4 x 3 x 5 x 3/4



CORNER ROUND 2-FLUTE BEARING

NEW PART #	OLD PART #	
W-2000A	4000	1/16 x 5/8 x 1/2 x 1-3/4 x 1/4
W-2000C	4002	1/8 x 3/4 x 1/2 x 1-7/8 x 1/4
W-2000	4004	3/16 x 7/8 x 1/2 x 1-7/8 x 1/4
W-2001	4006	1/4 x 1 x 1/2 x 1-7/8 x 1/4
W-2006	4008	1/4 x 1 x 1/2 x -2-1/4 x 1/2
W-2002	4009	5/16 x 1-1/8 x 1/2 x 1-5/16 x 1/4
W-2007	4010	5/16 1-1/8 x 1/2 x 2-1/4 x 1/2
W-2003	4012	3/8 x 1-1/4 x 5/8 x 2 x 1/4
W-2008	4014	3/8 x 1-1/4 x 5/8 x 2-1/4 x 1/2
W-2004	4016	1/2 x 1-1/2 x 3/4 x 2-1/4 x 1/4
W-2009	4018	1/2 x 1-1/2 x 3/4 x 2-7/16 x 1/2
W-2009A	4019	5/8 x 1-3/4 x 1 x 2-11/16 x 1/2
W-2010	4020	3/4 x 2 x 1 x 2-3/4 x 1/2
W-2012	4023	1 x 2-1/2 x 1-5/16 x 3.188 x 1/2



SC COMPRESSION SPIRALS 2+2

SCSC-142	1/4 x 1 x 2-1/2 x 1/4
SCSC-516	5/16 x 7/8 x 3 x 5/16
SCSC-38	3/8 x 1-1/4 x 3 x 3/8
SCSC-12A	1/2 x 1-1/4 x 3 x 1/2
SCSC-12B	1/2 x 1-5/8 x 3-1/2 x 1/2
SCSC-12C	1/2 x 2 x 4 x 1/2
SCSC-58	5/8 x 1-1/2 x 4 x 5/8
SCSC-34	3/4 x 2 x 5 x 3/4

Premium Grade

SCSC-38-S	3/8 x 1-1/4 x 3 x 3/8
SCSC-12A-S	1/2 x 1-1/4 x 3 x 1/2
SCSC-12B-S	1/2 x 1-5/8 x 3-1/2 x 1/2

Standard Grade Mortise Tip (shorter up cut)

SCSC-38-M	3/8 x 1 x 3 x 3/8 MORT
SCSC-12A-M	1/2 x 1-1/4 x 3 x 1/2 MORT
SCSC-12B-M	1/2 x 1-5/8 x 3-1/2 x 1/2 MORT

Premium Grade Mortise Tip (shorter up cut)

SCSC-38M-S	3/8 x 1 x 3 x 3/8 MORT
SCSC-12AM-S	1/2 x 1-1/4 x 3 x 1/2 MORT
SCSC-12BM-S	1/2 x 1-5/8 x 3-1/2 x 1/2 MORT



SC COMPRESSION SPIRALS 3+3

SCSC-38A-3	3/8 x 1-1/4 x 3 x 3/8
SCSC-12A-3	1/2 x 1-1/4 x 3 x 1/2
SCSC-12B-3	1/2 x 1-5/8 x 3-1/2 x 1/2





TCT 2-FLUTE STRAIGHT PLUNGE

NEW PART #	OLD PART #	
W-SC09A	1001	1/8 x 3/8 x 1-1/2 x 1/4
W-SC11A	1002	3/16 x 1/2 x 2 x 1/4
W-1012	1004	1/4 x 1/2 x 2 x 1/4
W-1013	1005	1/4 x 3/4 x 2-1/4 x 1/4
W-1014	1006	1/4 x 1 x 2-1/2 x 1/4
W-1016	1006-XL	1/4 x 1 x 3 x 1/4
W-1018	1007	9/32 x 1 x 3 x 1/4
W-1022	1014	3/8 x 1 x 2-1/2 x 1/4
W-1026	1017	1/2 x 1 x 2-1/2 x 1/4
W-1030	1022	3/4 x 3/4 x 2-1/8 x 1/4
W-1058	1051	1/4 x 3/4 x 2-3/8 x 1/2
W-1060	1053	5/16 x 1 x 2-5/8 x 1/2
W-1062	1054	3/8 x 1 x 2-5/8 x 1/2
W-1063	1054B	3/8 x 1-1/4 x 2-7/8 x 1/2
W-1065	1055A	7/16 x 1-1/4 x 2-7/8 x 1/2
W-1066	1057	1/2 x 1 x 2-5/8 x 1/2
W-1067	1059	1/2 x 1-1/4 x 2-7/8 x 1/2
W-1069	1061	1/2 x 1-1/2 x 3-1/8 x 1/2
W-1070	1062	1/2 x 1-1/2 x 4-1/8 x 1/2
W-1072	1063	1/2 x 2 x 4-1/8 x 1/2
W-1073	1064	1/2 x 2-1/2 x 4-3/8 x 1/2
W-1074	1065	17/32 x 1-1/4 x 2-7/8 x 1/2
W-1075	1066	9/16 x 1-1/4 x 3 x 1/2
W-1077	1067	5/8 x 1-1/4 x 3 x 1/2
W-1078	1068	5/8 x 1-1/2 x 3 x 1/2
W-1083	1070	11/16 x 1-1/4 x 3 x 1/2
W-1084	1073	3/4 x 1 x 2-3/4 x 1/2
W-1085	1074	3/4 x 1-1/4 x 3 x 1/2
W-1086	1075	3/4 x 1-1/2 x 3-1/4 x 1/2
W-1088	1076	25/32 x 1-1/4 x 3 x 1/2
W-1087	1077	3/4 x 2 x 3-5/8 x 1/2
W-1093	1080	1 x 1-1/4 x 3 x 1/2
W-1096	1081	1-1/8 x 1-1/2 x 3 x 1/2
W-1097	1082	1-1/4 x 1-1/2 x 3 x 1/2
W-1099	1084	1-1/2 x 1-1/4 x 3 x 1/2
W-1100	1086	1-3/4 x 1-1/4 x 3 x 1/2



TCT LAMINATE TRIM 2&3 FLUTE

W-2401	3006	3/8 x 1/2 x 2-1/8 x 1/4
W-2400	3007	3/8 x 1 x 2-5/8 x 1/4
W-2403	3009	1/2 x 1 x 2-5/8 x 1/4
W-2402	3010	1/2 x 1 x 2-5/8 x 1/4
W-2405	3012	1/2 x 1 x 3-1/4 x 1/2
W-2407	3014	1/2 x 1-1/2 x 3-5/8 x 1/2
W-2408	3016	1/2 x 2 x 4 x 1/2
W-2500	3018	1/2 x 1 x 2-5/8 x 1/4 3-FLT
W-2502	3020	1/2 x 1 x 3-1/4 x 1/2 3-FLT



TCT TEMPLATE TRIM BIT 2-FLUTE

NEW PART #	OLD PART #	
W-3001	3100	1/2 x 1/2 x 2 x 1/4
W-3004	3104	1/2 x 1 x 2-1/2 x 1/4
W-3008	3105	5/8 x 1 x 2-1/2 x 1/4
W-3012	3107	3/4 x 3/4 x 2-3/8 x 1/4
W-3014	3107-XL	3/4 x 1 x 2-5/8 x 1/4
W-3020	3111	3/4 x 1 x 2-3/4 x 1/2
W-3023	3111A	3/4 x 2 x 3-5/8 x 1/2 straight flute
W-3018	3112	1-1/8 x 1-1/2 x 3-1/2 x 1/2
W-3019	3114	1-1/8 x 2 x 4 x 1/2



SOLID CARBIDE LAMINATE TRIM

W-SC28B	3300	FLUSH x 1/4 x 1/4 x 1-1/2 x 1/4
W-SC29	3302	7deg x 1/4 x 1/4 x 1-1/2 x 1/4
W-SC28C	3305	Dado/Flush 1/4 x 1/4 x 1-1/2 x 1/4



BEVEL TRIM

W-2300A	3403	15deg x 2 flute x 1/4 x 2 x 1/4
---------	------	---------------------------------

Conversion Table

Inches	Inches	Millimeter	Inches	Inches	Millimeter
1/64	.015625	.397	33/64	.515625	13.097
1/32	.03125	.794	17/32	.53125	13.494
3/64	.046875	1.191	35/64	.546875	13.891
1/16	.0625	1.588	9/16	.5625	14.288
5/64	.078125	1.984	37/64	.578125	14.684
3/32	.09375	2.381	19/32	.59375	15.081
7/64	.109375	2.778	39/64	.609375	15.478
1/8	.125	3.175	5/8	.625	15.875
9/64	.140625	3.572	41/64	.640625	16.272
5/32	.15625	3.969	21/32	.65625	16.669
11/64	.171875	4.366	43/64	.671875	17.066
3/16	.1875	4.763	11/16	.6875	17.463
13/64	.203125	5.159	45/64	.703125	17.859
7/32	.21875	5.556	23/32	.71875	18.256
15/64	.234375	5.953	47/64	.734375	18.653
1/4	.25	6.350	3/4	.75	19.050
17/64	.265625	6.747	49/64	.765625	19.447
9/32	.28125	7.144	25/32	.78125	19.844
19/64	.296875	7.541	51/64	.796875	20.241
5/16	.3125	7.938	13/16	.8125	20.638
21/64	.328125	8.334	53/64	.828125	21.034
11/32	.34375	8.731	27/32	.84375	21.431
23/64	.359375	9.128	55/64	.859375	21.828
3/8	.375	9.525	7/8	.875	22.225
25/64	.390625	9.922	57/64	.890625	22.622
13/32	.40625	10.319	29/32	.90625	23.019
27/64	.421875	10.716	59/64	.921875	23.416
7/16	.4375	11.113	15/16	.9375	23.813
29/64	.453125	11.509	61/64	.953125	24.209
15/32	.46875	11.906	31/32	.96875	24.606
31/64	.484375	12.303	63/64	.984375	25.003
1/2	.5	12.700	1	1	25.4



European Tooling Systems, founded in 1989, is a complete supplier to the industrial woodworking community. E.T.S. offers a full range of German-made saw blades featuring a special grade of carbide designed for cutting MDF and melamine products. We offer one of the largest available inventories of metric boring bits in either the carbide-tipped or solid carbide style. In addition to these items, we also carry a wide range of other cutting tools including: high speed corrugated steel and planer knives, disposable carbide inserts in many different grades for different materials, and CNC router bits.

E.T.S. offers superior customer service by providing technical assistance, one-stop purchasing, and innovative solutions. We keep all of our quality, imported tooling in stock and offer a variety of shipping methods to increase efficiency. We would appreciate a chance to show you how our expanded inventory and low pricing can help you meet your tooling needs.

E.T.S. Headquarters
P.O. Box 1504
205 Creekside Drive
Washington, NC 27889

PHONE: 800.835.3660
252.975.8075

Fax: 252.975.2241

Email: eupeantooling@earthlink.net

On The Web: www.europeantooling.com